

ITEM NO.	PART NUMBER	DESCRIPTION	DRAWING #	Default/ QTY.
1	BO-1/2x1-1/2 SHCS	BOLT SOCKET HEAD 1/2x1-1/2	STOCK	2
2	BO-.3125x2x5 U BOLT	BOLT 5/16x2x5 SQ	95-2217	2
3	BO-3/8 FW	FLAT WASHER 3/8	STOCK	4
4	BO-3/8x1 HCS	BOLT 3/8 x 1	STOCK	4
5	BO-3/8 LW	LOCK WASHER 3/8	STOCK	4
6	BO-1/2 FLAT WASHER	1/2" FLAT WASHER	STOCK	2
7	FP-EL-HUB .753 ID	KEYED HUB, 1.8 OD. .753 ID W/ 3/16 KEYWAY	30-2418	1
8	FP-EL-HF-COVER	ELECTRIC FEEDER ADAPTER BOX W/DMT.	30-1410	1
9	FP-HF12-22A	LIFT BRACKET BAR	30-2223	2
10	HF-HF-1800	HYDRA-FEEDER 1800	30-1307	1
11	HF-KHF-A EXT	AUGER EXTENSION HYDRA FEEDER	30-1409	1
12	HF-KHF-DISC8	HYDRA-FEEDER 8" DISCHARGE KIT	30-1408	1

REVISIONS			
REV.	DESCRIPTION	DATE	APPROVED
A	INITIAL RELEASE	10/16/2013	

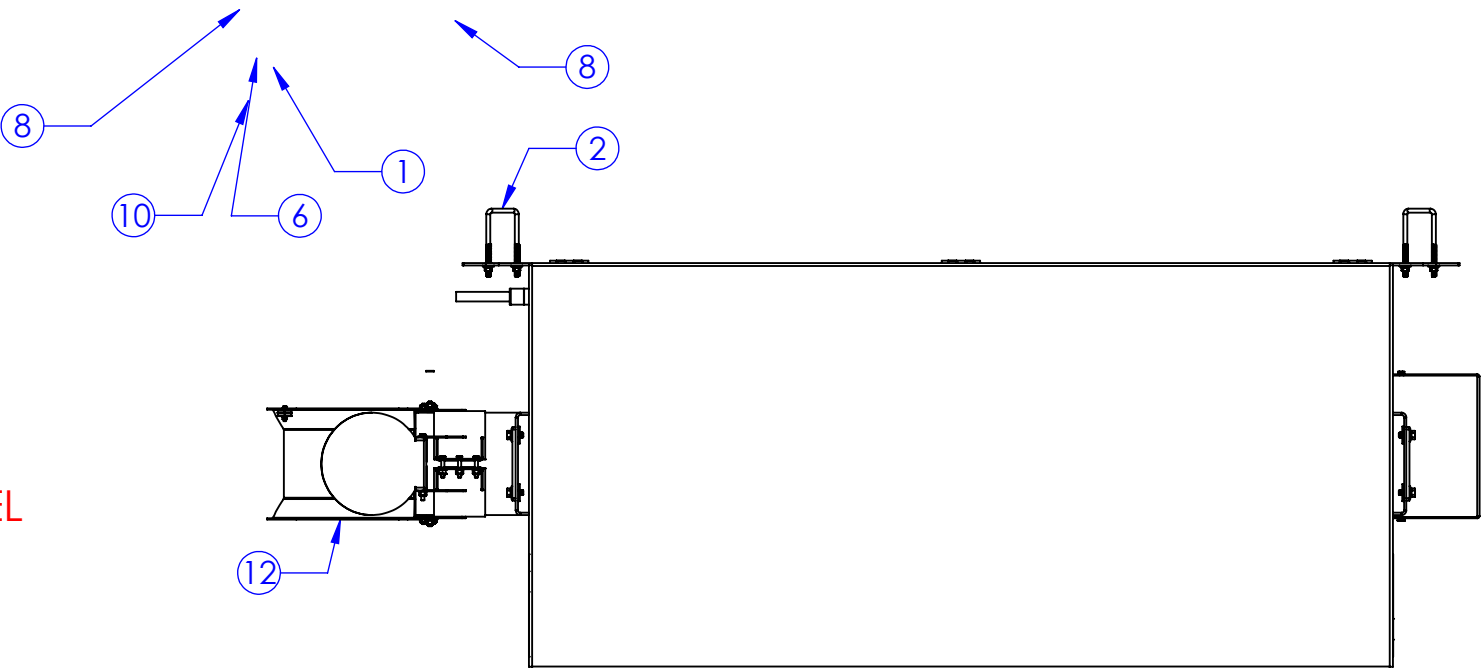

BOM IS FROM HF-PBEL
SEE 30-1803 FOR
MORE DETAILS

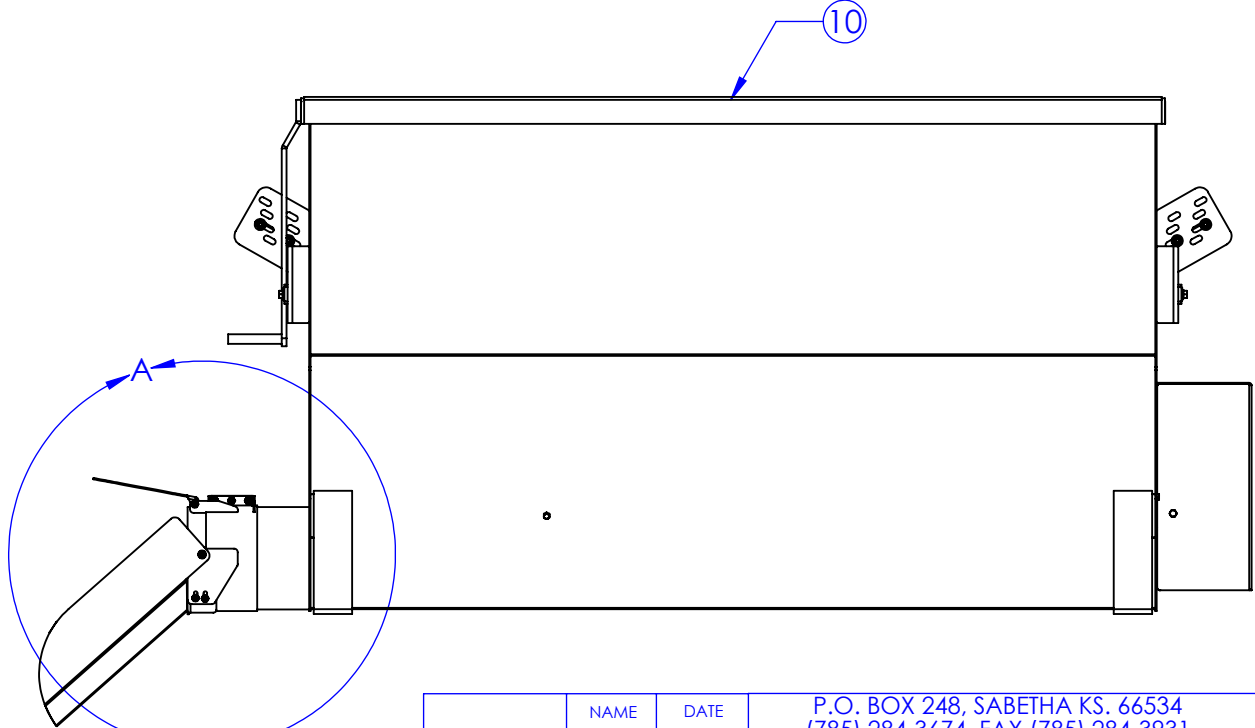
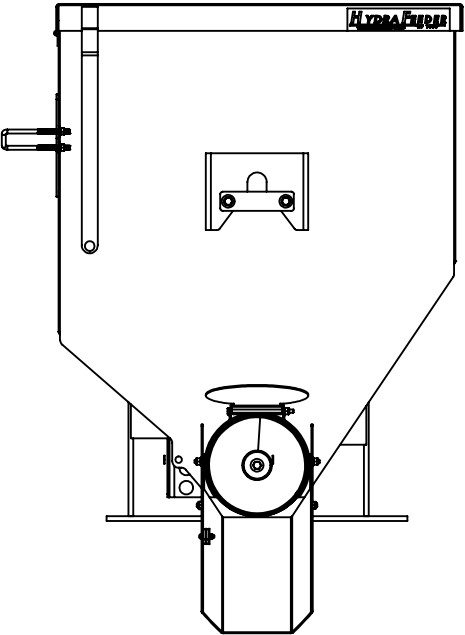
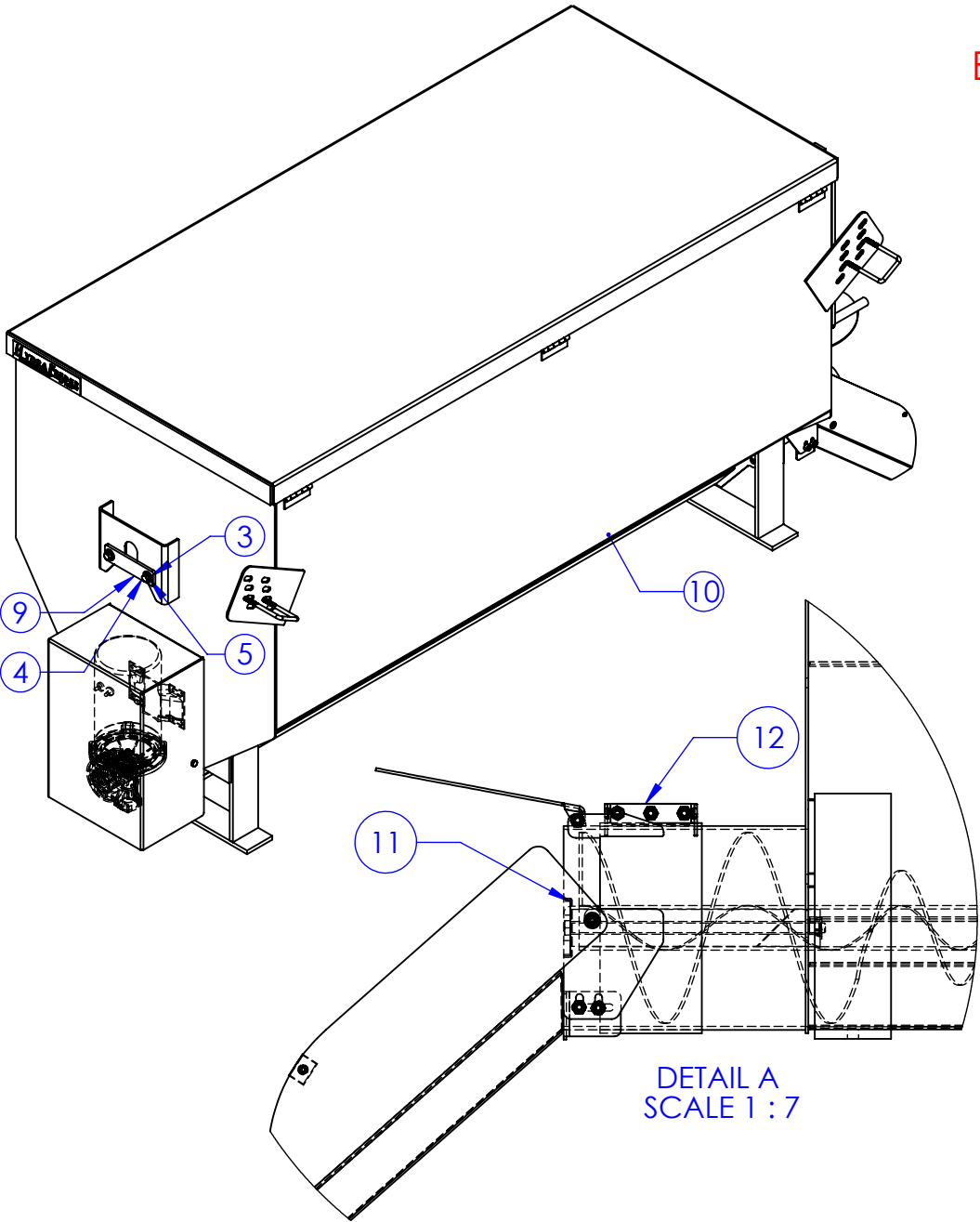

DETAIL A
SCALE 1 : 7

PROPRIETARY AND CONFIDENTIAL
THE INFORMATION CONTAINED IN THIS
DRAWING IS THE SOLE PROPERTY OF
<INSERT COMPANY NAME HERE>. ANY
REPRODUCTION IN PART OR AS A WHOLE
WITHOUT THE WRITTEN PERMISSION OF
<INSERT COMPANY NAME HERE> IS
PROHIBITED.

UNLESS OTHERWISE SPECIFIED:
DIMENSIONS ARE IN INCHES
TOLERANCES:
FRACTIONAL $\pm 1/16$
ANGULAR: MACH ± 1 BEND \pm
TWO PLACE DECIMAL ± 0.10
THREE PLACE DECIMAL ± 0.005
MATERIAL
DO NOT SCALE DRAWING

DRAWN		NAME	DATE	P.O. BOX 248, SABETHA KS. 66534 (785) 284-3674 FAX (785) 284-3931	
PART #		HEATH		10/16/2013	
ASM #					
COMMENTS:					
FINAL ASSEMBLY, HF-1800, ELECTRIC FEEDER					
SIZE B	DWG. NO. 30-0312	REV A			
SCALE: 1:15		WEIGHT: 563.91		SHEET 1 OF 1	